

1306 E 7TH STREET LOT C | DOOR 52

Physician Office Building 1306 (Suites A-D)

1st floor: Physician Offices, Suites A-D

1310 E 7TH STREET LOT C | DOOR 53

Physician Office Building 1310 (Suites F-M)

1st floor: Parkview Physicians Group, Suite F
DeKalb Health Specialty Clinic, Suite G
Physician Offices, Suites J-M, Pediatrics

1314 E 7TH STREET LOT C | DOOR 61

Physician Office Building 1314 (Suites 100-300)

1st floor: Physician Offices, PharmaCare,
Lutheran Heart (LMG), Indiana/Ohio Heart
2nd floor: Physician Offices: Family Medicine, ENT
Clinical Services: Wound, Ostomy, Coumadin
3rd floor: Conf. Rooms, Board Room, Information Technology,
Administration: Executive, Medical Group

1316 E 7TH STREET LOT E | DOOR 36

Physician Office Building 1316 (North Campus)

1st floor: Rehabilitation
DeKalb Business Health Services
Fort Wayne Orthopedics

1316 E 7TH STREET LOT B | DOOR 1

Inpatient | Visitor Entrance (Main Hospital)

1st floor: HR, Education, Community, Foundation,
Marketing, Corporate Health, Wellness,
Cafeteria, Cashier, Gift Shop
2nd floor: Inpatients: ICU, Med Surg (2nd)
Sleep Center, Social Services, Quality, QUEST, UR
3rd floor: Inpatients: Med Surg (3rd)

1316 E 7TH STREET LOT A | DOOR 3

Surgery | OB Entrance

1st floor: (Lot A | Door 3)
Auburn OB/GYN & Midwifery, Suite 2
Women's Health Advantage, Suite 3
Cardiopulmonary Rehabilitation

2nd floor: (Lot A | Door 3)
Family BirthPlace (OB)

3rd floor: (Lot A | Door 3)
Surgery (Pre-Admission Testing)

1316 E 7TH STREET LOT A | DOOR 4

Walk-In Clinic Entrance

1st floor: (Lot A | Door 4)
Walk-In Clinic, Suite 4
General Surgeon, Dr. Jeffrey Justice, Suite 5

1316 E 7TH STREET LOT A | DOOR 5

ER Entrance | Outpatient Entrance

1st floor: (Lot A | Door 5)
ER

2nd floor: (Lot A | Door 5)
Registration/Patient Access, Diabetes,
Lab/Respiratory/Imaging (Radiology/X-Ray)

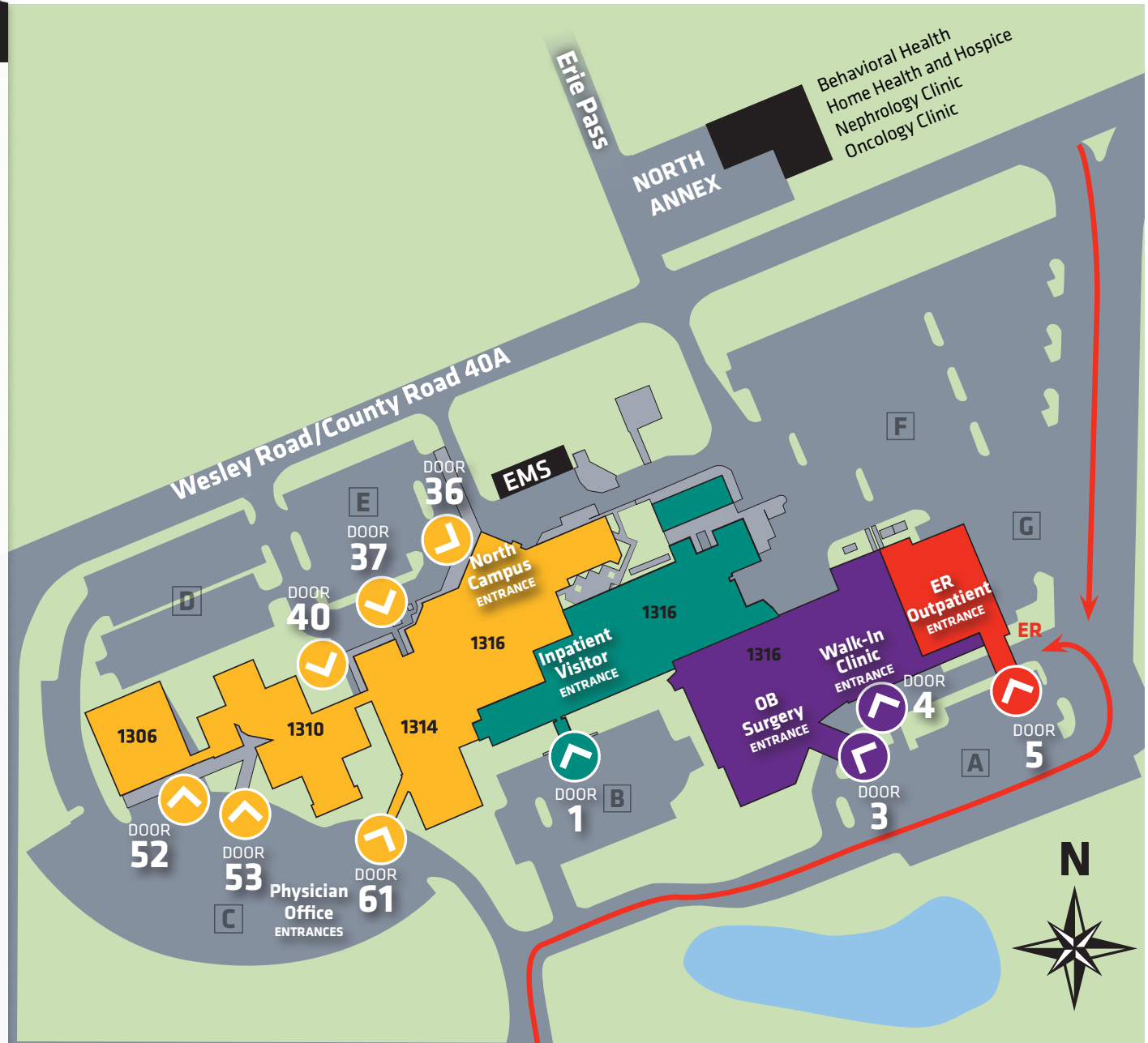

← I-69 (2.3 miles)

East Seventh Street/State Road 8

EAST CAMPUS (1700 E. 7th Street)
Central Business Office | Medical Records
CPR & PALS Training | IMPACT